

5-inch Attendance Terminal With Fingerprint Recognition



Accurate Recognition
Fast Face Recognition



Remote Door
Unlocking-Saves
Time and Effort



Binocular Detection
Liveness Anti-Spoofing



Fingerprint Unlocking-
High-Efficiency Access



Product Overview

WR502F binocular face recognition terminal integrates high-definition facial recognition cameras with advanced adaptive optics, delivering stable performance in extreme lighting conditions. It features fast recognition speed, high accuracy, and a large list capacity. It supports palm vein recognition, fingerprint door opening, and clock-in functions. Users can quickly unlock the door and clock in by fingerprint, ensuring safe and convenient access control and convenient attendance management. It can be used in conjunction with application management systems such as real-name management systems for construction sites, facial recognition access control and attendance management systems, and visitor management systems. It is perfectly suitable for complex application scenarios in communities, campuses, hospitals, scenic spots, hotels, shopping malls, office buildings of enterprises, public service places, construction sites, etc., where temperature monitoring, identity recognition, and access control are required.

Application Scenarios

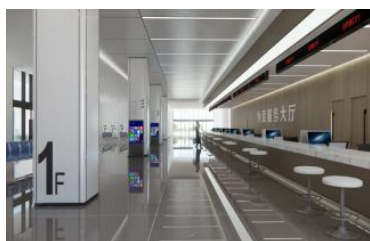

Library/dormitory door



Site/factory



Campus entrance and exit



Scenic area entrance and exit



Park commuting attendance



Office building access control



Product Features



Provides convenient access for unregistered visitors while ensuring security and enhancing user experience



API documentation provided with support for customized development



Supports both web-based remote upgrades and local USB drive updates



Instant fingerprint matching delivers a seamless and efficient access experience



Supports 5,000-face database with 99.99%+ recognition accuracy and <1s verification speed



Equipped with a smart doorbell function for seamless communication and instant notifications



100,000 facial recognition attendance records (with images)
1,000,000 log entries (image-free mode)



Operates independently without external network/server connection, capable of complete employee attendance recording and management



Product Appearance & Dimensions

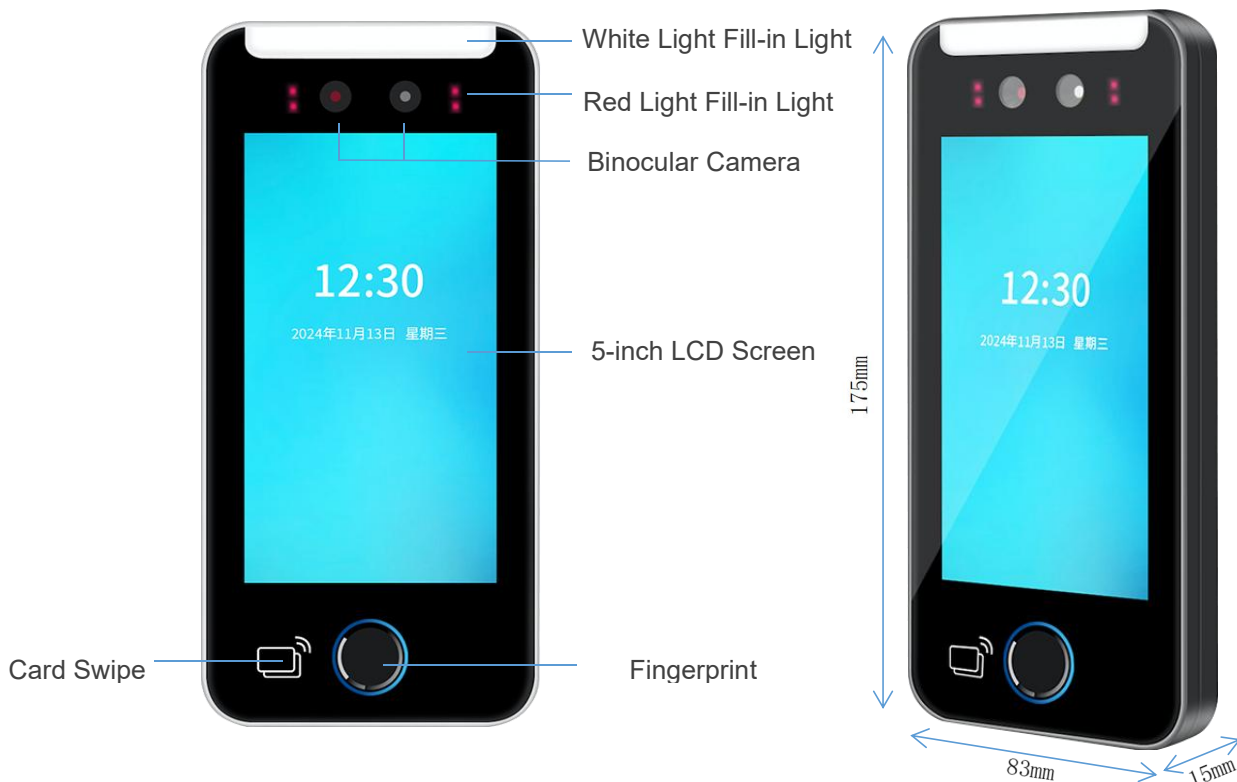

Cameras

Resolution	Dual 1MP (Megapixel)
Type	Binocular Camera
Aperture	F2.2
Focus Distance	50-150cm
White Balance (WB)	Automatic
Fill Light	LED/Dual IR Fill Lights

Screen

Size	5.0-inch IPS LCD Screen
Resolution	480x854
Touch	Support

Configuration

CPU	Single-Core CPU
NPU	1.0 TOPS
OS	Linux
Memory	EMMC 8G
Network Module	Ethernet, wireless (Wi-Fi), 4G (optional)
Audio	2w/8Ω
Card Reader	IC/ID card reader (optional)

System Functions

Face Database	5000 faces
---------------	------------

Password Capacity/Number	5000
1:N Face Recognition	Support
Liveness Detection	Support
Stranger Detection	Support
Recognition Distance	50-150cm
Recognition Speed	<1 second
Recognition Rate	99.99%
UI Interface Configuration	Support
Device Remote Upgrade	Support
API Interface	Device management, personnel/photo management, communication records, system settings
Deployment method	Support public cloud deployment, private deployment, LAN/stand-alone use

Standard Parameters

Power	12V 2A
Operating temperature	-10°C-60°C
Storage temperature	-20°C-70°C
Power consumption	20W (MAX)
Installation method	Wall Mounting
Protection level	IP54
Device size	175*83*15mm